

Electrolux

ELECTROLUX OUTDOOR PRODUCTS

brand	MEP
-------	------------

date	JAN/02	SHEET 1/3
------	--------	-----------

Model

MP - ER 546ESL

Product number

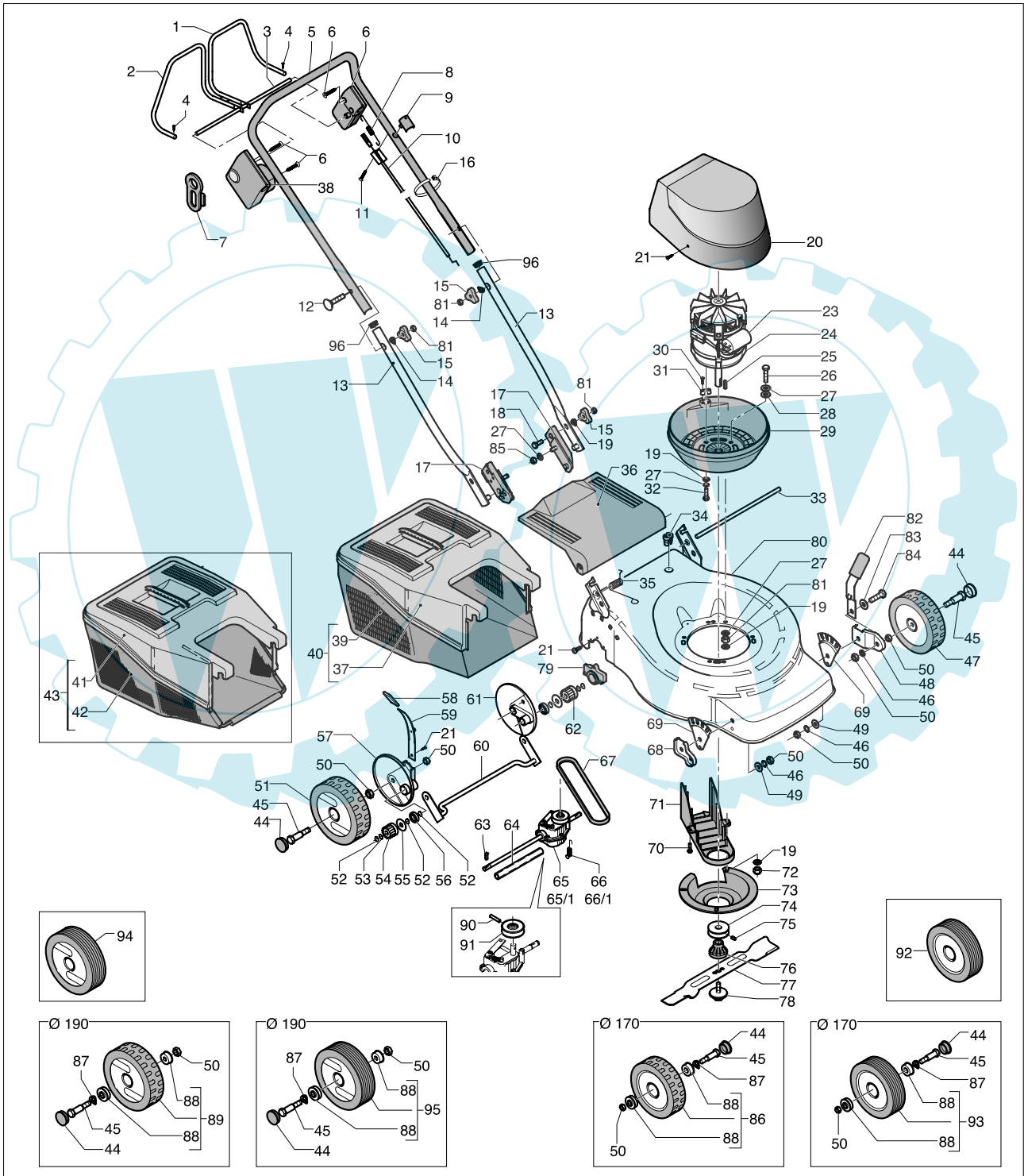

The Electrolux Group. The world's No.1 choice.

Ihr Ersatzteilspezialist im Internet

brand	MEP
-------	------------

date	JAN/02	SHEET 2/3
------	--------	-----------

MP - ER 546ESL

Pos.	PN ELX	PN MEP	DESCRIZIONE	DESCRIPTION	DESCRIPTION	Q.ty	NOTE
1	531206003	10146393	maniglia frizione	clutch lever	manette d'embrayage	1	
2	531205995	10146293	maniglia interruttore	switch lever	manette interrupteur	1	
3	531206004	10146403	tirante	tie rod	entretoise	1	
4	531206006	10146420	vite	screw	vis	2	D.3,9x13 FZ
5	531206002	10146363	manico superiore	upper handle	guidon superieur	1	
6	531207675	10734500	vite	screw	vis	2	TC TC 4x25
7	531207051	10393103	gancio	cable hook	crochet	1	
8	531206005	10146410	molla frizione	spring	ressort	1	
9	531205978	10146203	fissa cavo	cable lock	arret du cable	1	
10	531205990	10146250	cavo frizione	clutch cable	cable d'embrayage	1	1040/1154
11	531208217	20135730	vite	screw	vis	1	TC.TC 2F D 5x25
12	531207089	10402401	vite	screw	vis	2	TTSQ M8x50 TF ZB
13	531206071	10150133	manico inferiore	handle lowere	guidon inferieur	2	
14	531207090	10402402	rondella ondulata	washer	rondelle	2	8,5
15	531204923	10114303	pomolo	knob	poignée	4	
16	531205581	10135600	fascetta	clamp	colier	2	160X4,5
17	531207045	10391303	supporto manico	bearing	support	2	
18	531207071	10396600	vite	screw	vis	2	TE M8x30 UNI 5739-8,8-ZB
19	531204922	10114200	rondella piana	washer	rondelle	6	8x16x1,5 ZB
20	531205568	10135511	coprimotore	motor housing	carter moteur	1	MP
20	531205569	10135512	coprimotore	motor housing	carter moteur	1	ER
21	531208216	20135720	vite	screw	vis	5	TCTC2FD.x16 AC
23	531207721	10781700	condensatore	condenser	condensateur	1	20MF
24	531207685	10740000	motore	motor	moteur	1	1800W
25	531207041	10384800	chiavetta	key	clavette	2	4x4x22
26	531207044	10390800	vite	screw	vis	3	TE M8x40 UNI 5737-8,8-ZB
27	531207981	20106200	rondella dent.	washer	rondelle	12	D.8E DIN 6798
28	531204904	10066300	rondella piana	washer	rondelle	3	8x24x2
29	531207069	10396303	base coprimotore	motor housing bottom	fond du carter moteur	1	
30	531207065	10396100	vite	screw	vis	2	TCTC 3,9x22 FIX ZB
31	531207043	10389103	fissa cavo	cable lock	arret du cable	1	D.8/5
32	531208586	20385300	vite	screw	vis	4	TE M8x25 UNI 5739-8,8-ZB
33	531205060	10120530	tirante	tie rod	entretoise	1	
34	531205557	10135413	fermacavo	cable lock	arret du cable	1	
35	531205999	10146330	molla paratoria	spring	ressort	1	
36	531205982	10146211	paratoia	deflector	deflecteur	1	MP
36	531205983	10146212	paratoia	deflector	deflecteur	1	ER
37	531208296	20146113	coperchio cestello	grass catcher upper	bac superieur	1	
38	531207082	10398400	interruttore	switch	interrupteur	1	9,5A
39	531208313	20146593	fondo cestello	grass catcher bottom	bac inferieur	1	
40	531204646	09146663	cestello completo	grass catcher	bac complet	1	
41	531205949	10146113	coperchio sacco con telaio	sack frame upper	cadre du sac superieur	1	
42	531208306	20146303	sacco nero	sac	sac	1	
43	531204642	09146573	sacco completo	grass catcher	sac complete	1	
44	531204936	10114804	tappo ruota	plug	bouchon	4	
45	531205042	10120090	vite ruota	screw	vis	4	
46	531208974	30102100	rondella dent.	washer	rondelle	4	10E
47	531205031	10120074	ruota	wheel	roue	2	D.170/13 TACCH.
48	531204915	10107302	supporto ruota	wheel bearing	support de roues	1	DX
49	531207989	20113000	rondella piana	washer	rondelle	2	10x30x2,5



brand	MEP
-------	------------

date	JAN/02	SHEET 3/3
------	--------	-----------

MP - ER 546ESL

Pos.	PN ELX	PN MEP	DESCRIZIONE	DESCRIPTION	DESCRIPTION	Q.ty	NOTE
50	531207978	20101700	dado	nut	écrou	10	M10 H8 UNI 5588-6S ZB
51	531205021	10120054	ruota	wheel	roue	2	D.190/13 TAC.-MP
52	531208772	20655800	seeger	seeger	seeger	6	D.12E DIN 471
53	531208859	20761300	rondella	washer	rondelle	2	D.12,4x17x0,3
54	531205045	10120160	pignone	pinion	pignon	1	DX
55	531207847	10831200	rondella piana	washer	rondelle	2	D.12/34/0,7 ZB
56	531208778	20657600	cuscinetto	ball-bearing	roulement	2	D.12/28/8 6001/2RS
57	531205194	10121663	flangia	flange	bride	1	
58	531207986	20107203	guaina	sheating	gaine	1	
59	531205228	10121970	leva alzaruote	lever	levier	1	
60	531205210	10121840	assale posteriore	rear axle	assieu arriere	1	
61	531205195	10121673	flangia	flange	bride	1	
62	531205046	10120170	pignone	pinion	pignon	1	SX
63	531205108	10121160	chiavetta	key	clavette	2	"S" 5x5(- 0,05)x19,2 DIAG
64	531207697	10766503	tubetto distanziale	spacer tube	toyau entretoise	1	
65	531204755	O9767400	riduttore	reducer	reducteur	1	
66	531205216	10121920	molla	spring	ressort	1	
65/1	531204759	O9767900	riduttore	reducer	reducteur	1	HA/20
66/1	531206182	10155210	molla	spring	ressort	1	
67	531207280	10548500	cinghia	belt	courroie	1	Z 27 3L 285
68	531204914	10107301	supporto ruota	wheel bearing	support de roues	1	SX
69	531210608	10146890	supporto leva	lever support	support levier	2	
70	531207856	10831800	vite	screw	vis	3	TEFR 5x10 ZB
71	531205047	10120183	carter cinghia	belt housing	carter de courroie	1	
72	531208599	20404900	dado	nut	écrou	3	M8 H10 UNI7473-ZB
73	531206007	10146433	carter di protezione	protection guard	carter de protection	1	
74	531205994	10146280	puleggia	pulley	pouile	1	
75	531205998	10146320	vite	screw	vis	1	M5X10 UNI 5929-67
76	531205993	10146273	supporto lama	bearing blade	support lame	1	
77	531205072	10120680	lama	blade	lame	1	
78	531207038	10380603	vite lama	screw	vis	1	
79	531205944	10146093	supporto ass.post.	support	support	2	
80	531210718	10172671	scocca	deck	chassis	1	MP
80	531210844	10172672	scocca	deck	chassis	1	ER
81	531207982	20106300	dado	nut	écrou	7	M8 H8 UNI 5587-6S ZB
82	531204913	10107203	leva alzaruote	lever	levier	2	
83	531206020	10146530	rosetta	washer	rondelle	2	UNI 8840 B12 (13/24/1)
84	531204912	10107100	vite	screw	vis	2	
85	531206618	10240300	dado	nut	écrou	2	M8 H5 UNI 5589-6S ZB
86	531204371	O9120084	ruota anteriore	front wheel	roue anterieur	2	D170/26 TAC.-MP
87	531206644	10275100	rosetta	washer	rondelle	4	UNI 8840- B12(13/24/0,8)
88	531205214	10121900	cuscinetto	ball-bearing	roulement	8	
89	531205024	10120064	ruota posteriore	posterior wheel	roue posterieur	2	D.190/26 C/INGR.TAC -MP
90	531207703	10768400	spina elastica	resilient pin	goupile expansible	1	
91	531208899	20768203	puleggia	pulley	pouile	1	
92	531205189	10121584	ruota	wheel	roue	2	D.170/13 RIGATA-ER
93	531204395	O9121574	ruota anteriore	front wheel	roue anterieur	2	D170/26 RIG.-ER
94	531205181	10121564	ruota posteriore	posterior wheel	roue posterieur	2	D.190/13-ER
95	531205177	10121554	ruota	wheel	roue	2	D.190/26 RIGATA - ER
96	531208950	20833303	tappo	plug	bouchon	2	

